

Site Concept

General Notes:

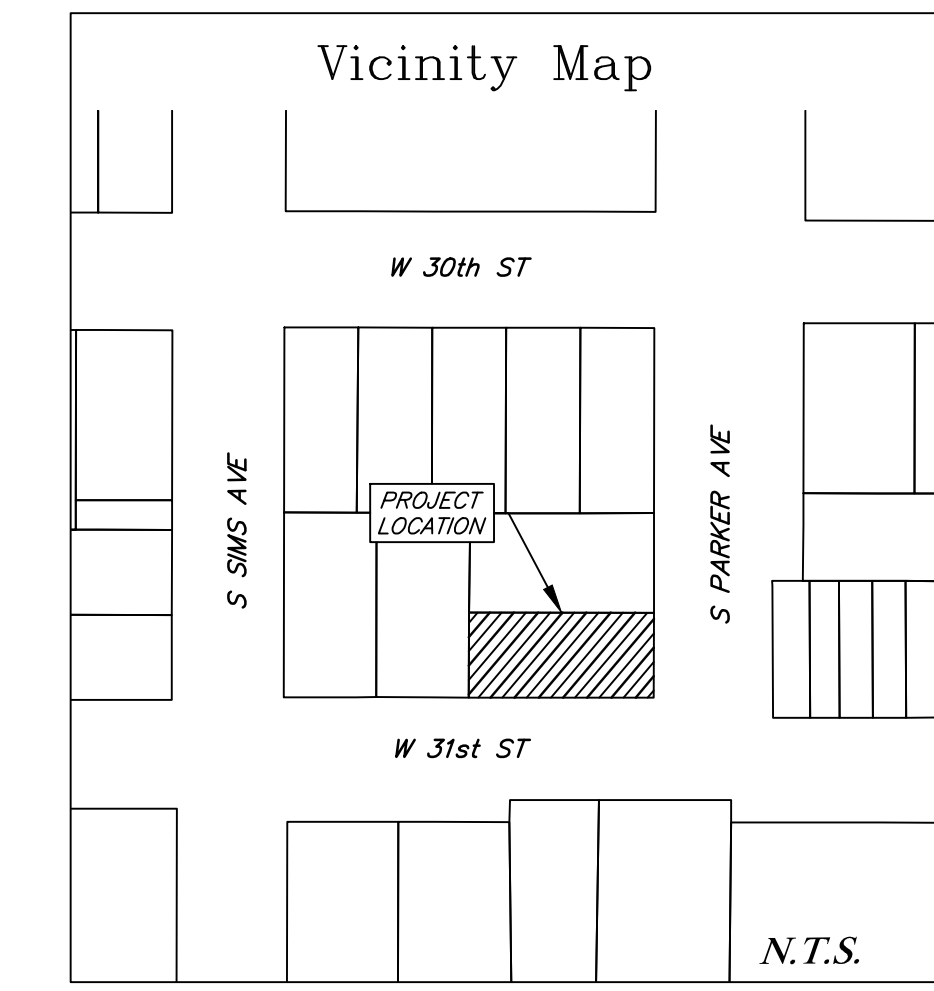
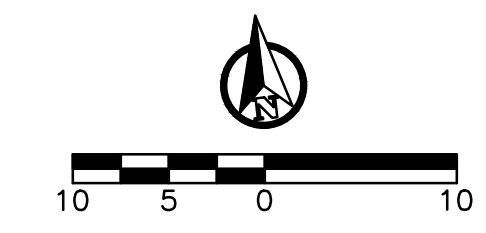

Parking Analysis:

| | |
|-------------------------|-----------------------------------|
| Proposed Improvements: | 6 Residential Units W/ 2 BedroomS |
| New Required Parking: | 6 1 Space per Bedroom |
| Total Proposed Parking: | 6... Straight In Parking |

Legend

| | |
|--|-------------------------------|
| | Proposed 6" Concrete Pavement |
| | Proposed 4" Concrete Sidewalk |
| | Proposed HMA Pavement |
| | Proposed Landscape Area |
| | Existing HMA Pavement |
| | Existing Concrete Sidewalk |
| | Existing Concrete Pavement |

| No. | Revision/Issue | Date |
|-----|----------------|------|
| | | |
| | | |

Firm Name and Address:
J4 Engineering
 PO Box 5192 - Bryan, Texas - 77805
 979-739-0567 www.J4Engineering.com
 Firm# 9951

Project Name and Address:
Garoppolo
 508 S. Parker Ave
 City of Bryan Townsite
 Block 135, Lots 3-5 - 0.17 Ac
 Bryan, Brazos County, Texas

Date: Oct 2022
 Scale:
 Sheet: **Exhibit A**

